

Flanged High Back Pressure Foam Makers

Fire Engineering
Pty Limited



Description

Our range of high back pressure foam makers are the best performing foam generators on the market. They are used for sub-surface foam systems and other applications where tolerance to high back pressures may be required from a foam generator. The FHBM Flanged range of high back pressure foam makers feature exceptional back pressure tolerance in stainless steel construction and with flanged connections.

Key features of the FHBM range are:

- At inlet pressures above 700 kPa the maximum back pressure allowed is 50% of the inlet pressure.
- At pressures as from 400 kPa to 700 kPa the maximum allowed back pressure is 40% of the inlet pressure.
- Cover a wide range of flow.
- Manufactured from 316 stainless steel.

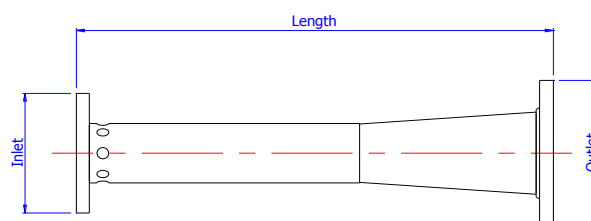

ORION FIRE ENGINEERING PTY LIMITED

ABN 80 002 538 696

26A LYN PARADE PRESTONS NSW 2170 AUSTRALIA

Tel (61) 2 9426 7900

FAX (61) 2 8783 5400

Visit our Website www.orion-fire.com.au Email: sales@orion-fire.com.au

Model Number	Part Number	Nominal Flow @ 700 kPa	Inlet Flange	Outlet Flange	Length	K-Factor
FHBM-500	12278	500	40mm	50mm	265mm	18.9
FHBM-600	13329	600	40mm	50mm	265mm	22.7
FHBM-700	12839	700	40mm	50mm	265mm	26.5
FHBM-800	13006	800	40mm	50mm	265mm	30.2
FHBM-900	12305	900	40mm	50mm	265mm	34.0
FHBM-1000	15859	1,000	50mm	80mm	305mm	37.8
FHBM-1200	12350	1,200	50mm	80mm	305mm	45.4
FHBM-1400	15613	1,400	50mm	80mm	305mm	52.9
FHBM-1600	12995	1,600	50mm	80mm	305mm	60.5
FHBM-1800	15308	1,800	50mm	80mm	305mm	68.0
FHBM-2000	14277	2,000	50mm	80mm	305mm	75.6
FHBM-2200	13106	2,200	80mm	80mm	375mm	83.2
FHBM-2400	15173	2,400	80mm	80mm	375mm	90.7
FHBM-2600	15037	2,600	80mm	100mm	440mm	98.3
FHBM-2800	12487	2,800	80mm	100mm	440mm	105.8
FHBM-3000	13553	3,000	80mm	100mm	440mm	113.4
FHBM-3500	14678	3,500	80mm	100mm	440mm	132.3
FHBM-4000	13781	4,000	100mm	150mm	690mm	151.2
FHBM-4500	12521	4,500	100mm	150mm	690mm	170.1
FHBM-5000	14920	5,000	100mm	150mm	690mm	189.0
FHBM-5500	13808	5,500	100mm	150mm	690mm	207.9
FHBM-6000	15641	6,000	100mm	150mm	690mm	226.8

Inlet and outlet flanges are ANSI #150, raised face. K-Factor is in lpm/kPa units.

Installation

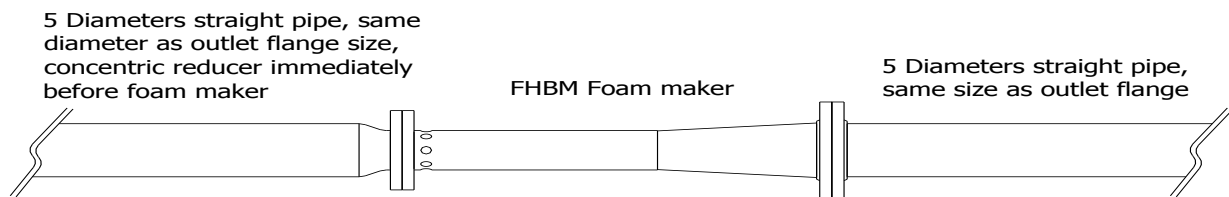

Weights

40-50 Models	50-80 Models	80-80 Models	80-100 Models	100-150 Models
6.5 kg	11.2 kg	14.9 kg	15.9 kg	23.2 kg

ORION FIRE ENGINEERING PTY LIMITED

ABN 80 002 538 696

26A LYN PARADE PRESTONS NSW 2170 AUSTRALIA

Tel (61) 2 9426 7900 FAX (61) 2 8783 5400

Visit our Website www.orion-fire.com.au Email: sales@orion-fire.com.au